

Table of Contents

- | [Modern Masterpiece](#)
- | [Video Tour](#)
- | [Comparable Sales](#)
- | [Floorplan](#)
- | [Property Inclusions](#)
- | [Relevant Documents](#)
- | [Around Heddon Greta](#)
- | [About Us](#)
- | [Disclaimer](#)

Modern Masterpiece



33 Connel Drive, HEDDON GRETA

Modern Masterpiece

4  2  2 

**Property
Preview**

Air Conditioning

Split System Air Conditioni
ng

Outdoor Entertaining

Fully Fenced

Built In Robes

Dishwasher

Home is where the heart is and a beautiful home boosts your happiness and confidence. Just three years young, great care was taken with the design of this beautiful Oracle Platinum built home, but nothing about the home is precious, it feels very welcoming and liveable. There's a sense of harmony that runs through the whole house which you'll just love.

Carrying the simple yet sophisticated colour palette of soft grey and white hues gives the open-plan kitchen and dining area its beautiful sense of flow. Open plan in design, visual drama is created in the kitchen through the use of stone benchtops and dark cabinetry.

Part of the master suite and separated at the front of the home for additional privacy, the ensuite is a breathing space walking into our ensuite is the thing I smile about most in my day says the current homeowner. With an understated style thanks to the elements including a recessed stone vanity top paired with a double shower there's nothing utilitarian about this heavenly pamper zone.

Situated on a flat block just shy of 700sqm and offering double gates at the side of the fully fenced yard to accommodate vehicles into the rear of the property and offering an undercover entertaining space decked out with town gas for the BBQ, ceiling fan and lights the family will

love being at home.

When you are placed just minutes from one of the Hunter's main arterial roads it changes more than the daily commute, you gain hours of home-making and a new look at family time. Barely 2 km from the Heddon Greta exit, it's time to give your family those extra hours each week, welcome to 33 Connell Dr, Heddon Greta.

This property is proudly marketed by Patrick Howard contact 0408 270 313 or 4933 5544 for further information or to book your onsite one on one inspection.

First National David Haggarty, We Put You First

Disclaimer: All information contained herein is gathered from sources we deem to be reliable. However, we cannot guarantee its accuracy and interested persons should rely on their own enquiries.

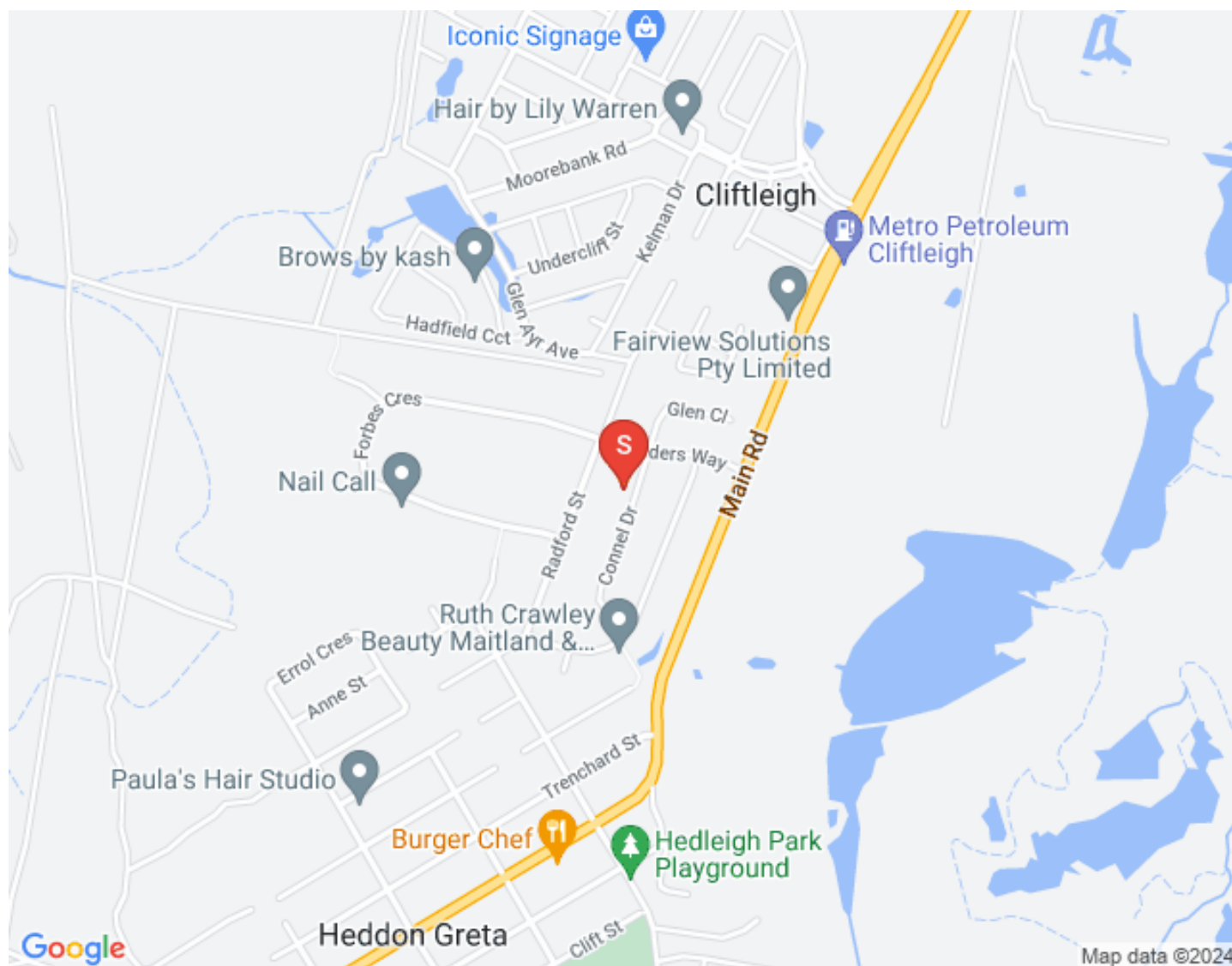

Video Tour

Comparable Sales



24B CONNEL DRIVE, HEDDON GRETA NSW 2321

4 Bed | 2 Bath | 2 Car
\$580,000
Sold ons: 21/09/2020



13 ASHTON DRIVE, HEDDON GRETA NSW 2321

4 Bed | 2 Bath | 2 Car
\$615,000
Sold ons: 02/09/2020



79 MAIN ROAD, HEDDON GRETA NSW 2321

4 Bed | 2 Bath | 4 Car
\$600,000
Sold ons: 07/09/2020



10 GULLANE CLOSE, HEDDON GRETA NSW 2321

4 Bed | 2 Bath | 2 Car
\$550,000
Sold ons: 11/09/2020



94 MAIN ROAD, HEDDON GRETA NSW 2321

4 Bed | 2 Bath | 2 Car
\$590,000
Sold ons: 08/12/2020



4 MOOREBANK ROAD, CLIFBLEIGH NSW 2321

4 Bed | 2 Bath | 4 Car
\$590,000
Sold ons: 20/01/2021

The CoreLogic Data provided in this publication is of a general nature and should not be construed as specific advice or relied upon in lieu of appropriate professional advice. While CoreLogic uses commercially reasonable efforts to ensure the CoreLogic Data is current, CoreLogic does not warrant the accuracy, currency or completeness of the CoreLogic Data and to the full extent permitted by law excludes all loss or damage howsoever arising (including through negligence) in connection with the CoreLogic Data.

Floorplan

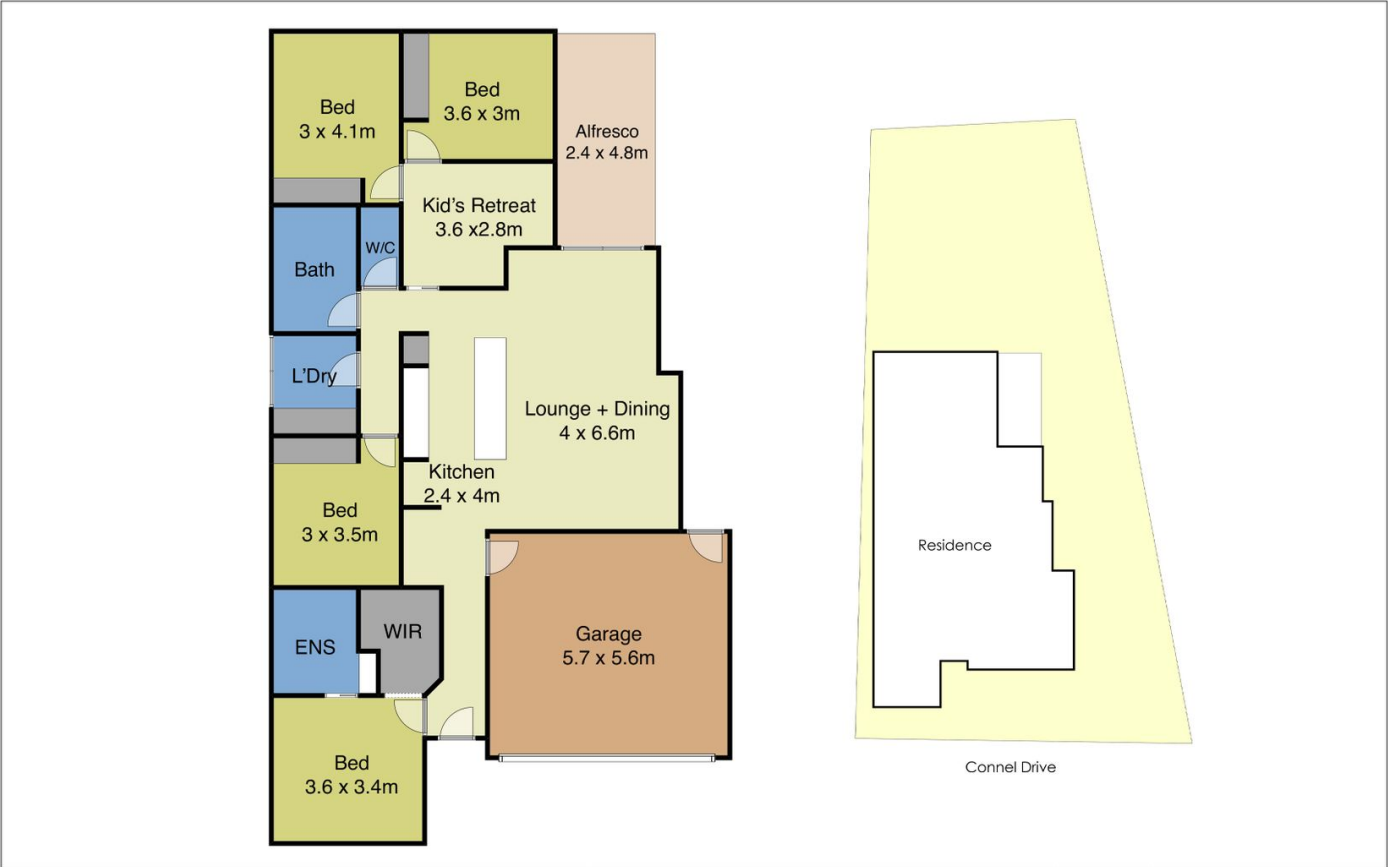

 first national REAL ESTATE David Haggarty	33 Connel Drive, Heddon Greta		NOT TO SCALE <small>Disclaimer: This plan and measurements are for informational purposes only. We make no warranties or representations, express or implied, as to the accuracy of the data. Independent detail verification is recommended.</small>
---	----------------------------------	---	---

Property Inclusions

Front Yard

Dark brick and tile construction

Front porch

Double remote garage

Security cameras

Double car gate access to yard

Concrete drive

Driveway ag drain

Main Bedroom

Charcoal berber carpet

White plantation shutters

Fujitsu AC

Ceiling fan | light

Grey wall tiles

3 double power point

Two pendant reading lights

TV connection

Walk in robe

Aluminium Awning windows

Ensuite

Charcoal floor tiles

Double shower

Clear glass sliding shower screen

Marble look wall tiles

Double towel rail

Two shower heads

Double shower rails

Ceiling exhaust

Sliding window

Plantation shutters

Grey wall paint

Wall mounted mirror

Floating vanity

Vanity neish

Living | Dining

Marble look floor tiles

Study nook

Grey painted walls

Fujitsu inverter AC

Downlights

2 aluminium sliding windows

Roller blinds

TV connection 4 double power points

Sliding glass door

Kitchen

Breakfast bar

Double door pantry

Double fridge cavity

Downlights

Dark timber laminate cupboards

Subway tile

Double sink

Stone benches

900 stainless steel under bench electric oven

5 burner stainless steel gas stove

Retractable stainless steel range

Stainless steel dishwasher

Microwave neish

Play room

Marble look floor tiles

Grey painted wall tiles

Aluminium window

Roller blind

Downlights

Smoke alarm

TV outlet

2 double power points

Bedrooms 2 -4

Charcoal berber carpet

Grey painted walls

Wall shelves

Double door robe

Aluminium sliding window

Roller blind

Ceiling fan | light

Hisense AC to third bed

Main Bathroom

Charcoal floor tiles

Free standing shower

Clear glass shower screen

Rail shower screen

Exhaust fan

Single vanity

Marble look wall tiles

Double towel rail

Deep bath

Plantation shutters

Grey painted walls

Downlight

Separate WC

Rear

Grey painted concrete flooring entertaining area

Alfresco roof

Ceiling fan light

Security cameras

Sharif roller blind

Flat yard

Rear car access

Garage pedestrian access

Water tank

Fully fenced

Extras

Flyscreens

Oracle Platinum built home

3 years

NBN connection

Gas instantaneous hot water

Relevant Documents

[Contract of Sale](#)

[Rental Estimate Letter](#)

Around Heddon Greta

Heddon Greta

Much more to this area than just the historic drive in, Heddon Greta has seen a massive growth period since the opening of the Hunter Expressway, as Newcastle families seek more affordable housing out of the city but still within easy reach of work and family. The housing development of Cliftleigh Meadows has allowed the suburb expansion and is much sort after in both the first home buyer and investment markets, with a large rental demand as well.

Schools

- Kurri Kurri Public School
- Kurri Kurri High School
- Kurri Kurri TAFE

Cafes and Restaurants

- Heddon Greta Pub
- Heddon Greta Bakehouse
- May & Seng Chinese
- Burger Chef Heddon Greta

Activities

- Heddon Greta Drive In
- Kurri Golf Club
- Kurri Kurri Indoor Aquatic & Fitness Centre

About Us



PAT HOWARD

PARTNER | CLASS 1 LICENCED REAL ESTATE
AGENT

0408 270 313

pat@fnrem.com.au

A company Partner and one of the four Principal agents at First National Real Estate Maitland, Pat has been a Sales Agent with us since 2014 and brings a compassionate and enthusiastic approach to Real Estate in Maitland.

Having resided in Maitland for over 20 years, Pat has gained a vast knowledge of the area and is committed to it prospering. Pat is heavily involved in the community in particular, donating his time and services to the Maitland Rugby Club of which he is currently the President. Pat is regularly asked to conduct charity auctions and fund raise for many local charities and events including Red Nose Day Hunter, Gotcha 4 Life and Tomorrow Man, Run DIPG and The Shit Box Rally. Annually Pat swims and raises money for Laps for Life in memoriam to Angus Latham, taken too soon.

With a successful career of sales in both the Manufacturing and the Entertainment industry prior to real estate, Pat has a plethora of experience in dealing with a vast range of people in all situations.

Communication and attention to detail are paramount in Pat's ethos, to deliver the best service to his clients. He will ensure that all avenues are exhausted to guarantee the best price is obtained for his vendors. If you would like someone who you can trust to look after your biggest asset and be provided the highest quality service then give Pat a call.



KAITLIN CROWE

CLASS 2 LICENCED REAL ESTATE AGENT /
ASSISTANT & ANNUAL LEAVE RELIEF PROPERTY
MANAGER

kaitlin@fnrem.com.au

With proven strengths in Customer Service, Kaitlin brings warmth, positivity and exuberance to First National Maitland's Property Management Department. Previously completing a Traineeship in Real Estate with flying colours, Kaitlin was promoted to a Junior Property Manager within the FN Maitland organization, of which she took out the award for Property Manager Rookie of the year within the First National NSW network in 2019, for her dedication and overall performance to the job at hand. Working within the Property Management Department and having also incorporated Sales Experience into her career, this makes her well rounded in Real Estate abroad.

Kaitlin is highly organised and keen to make an impact and delivers invaluable support to our Property Managers Jazmine and Lillianne. Her enthusiastic approach, makes her a delight to work with and you can be assured Kaitlin will always have your best interests at heart!

Disclaimer

First National David Haggarty a declare that all information contained herein is gathered from sources we deem to be reliable. However, we cannot guarantee its accuracy and interested persons should rely on their own inquiries.

All images in this e-book are the property of First National David Haggarty. Photographs of the home are taken at the specified sales address and are presented with minimal retouching. No elements within the images have been added or removed.

Plans provided are a guide only and those interested should undertake their own inquiry.